

KRUEGER SENTRY GAUGE

Assembly Instructions For Transmitter

Transmitter Wire Connections:

RED = 9-12 VDC – Input

White = Signal Output – 4-20 mA

Black = GND

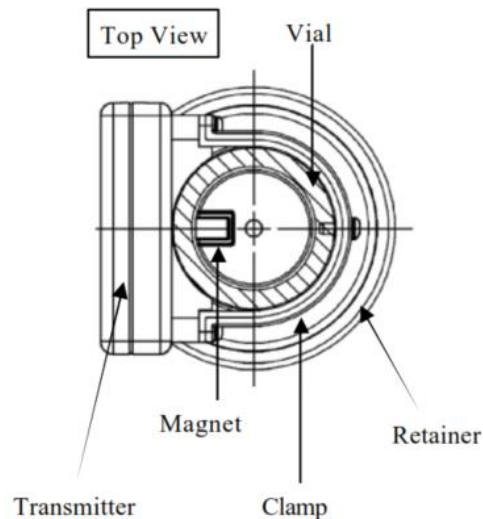
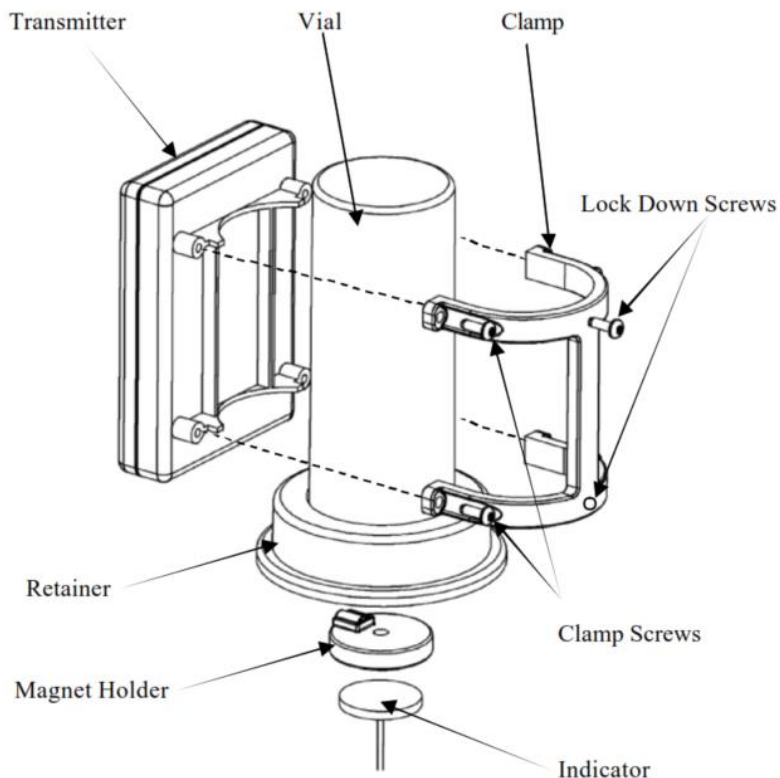
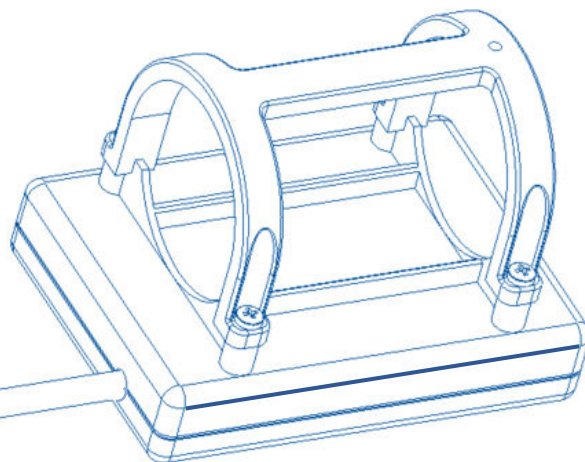

Krueger Sentry Gauge
1873 Siesta Lane
Green Bay, WI 54313

www.ksentry.com



Contact us for help or a local distributor:

Ph: 920-434-8860

Fax: 920-434-8897

Email: info@ksentry.com